

## REMOVAL

1. **REMOVE HOOD**
2. **REMOVE ENGINE UNDER COVERS**
3. **DRAIN ENGINE COOLANT**
4. **DRAIN ENGINE OIL**
5. **REMOVE V-BANK COVER**
6. **REMOVE BATTERY**
7. **REMOVE AIR CLEANER CAP AND INTAKE AIR CONNECTOR PIPE ASSEMBLY**
8. **REMOVE RADIATOR RESERVOIR**
  - (a) Disconnect the clamp on the wire from the reservoir.
  - (b) Disconnect the reservoir hose from the radiator.
  - (c) Remove the 2 bolts, reservoir and grommet.
9. **REMOVE RADIATOR AND FAN SHROUD**
  - (a) Disconnect the upper radiator hose from the front water bypass joint.
  - (b) Remove the 2 nuts, and disconnect the 2 clamps on the A/C discharge tube from the bracket.
  - (c) Remove the 2 bolts, and disconnect the 2 brackets on the wire from the radiator.
  - (d) Remove the 3 bolts, and disconnect the fan shroud from the radiator.
  - (e) Remove the lower radiator hose.
  - (f) Disconnect the 2 A/T oil cooler hoses from the radiator.
  - (g) Remove the 2 bolts, 2 nuts, 2 support collars and radiator.
  - (h) Remove the fan shroud.
10. **REMOVE GENERATOR DRIVE BELT, FAN, FLUID COUPLING AND FAN PULLEY**
  - (a) Loosen the 4 nuts holding the fluid coupling to the fan bracket.
  - (b) Remove the generator drive belt. (See page [CH-8](#))
  - (c) Remove the 4 nuts, the fan, fluid coupling assembly and fan pulley.
11. **DISCONNECT ENGINE WIRE FROM CABIN**
  - (a) Remove these parts:
    - (1) Glove compartment door
    - (2) Lower No.2 panel
  - (b) Disconnect the 3 connectors from the ECM.
  - (c) Remove the 3 screws, and disconnect the ECM from the body bracket.
  - (d) Disconnect the 3 wire harness connectors.
12. **DISCONNECT HOSES, WIRES, CONNECTORS, CLAMPS, GROMMET AND CABLES**
  - Accelerator cable from engine
  - 2 PS air hoses from hose clamp on No.3 RH timing belt cover
  - Generator wire
  - Generator connector
  - Hose clamp for PS air hose

- PS air hose from upper intake manifold
- 2 heater hoses
- Engine wire clamp from bracket on cowl panel
- Engine wire grommet from cowl panel
- Ground strap connector
- Fuel inlet hose and clamps
- Fuel return hose and clamp
- Air inlet hose from charcoal canister
- EVAP hose from charcoal canister
- Engine wire from clamp on right fender apron
- Clamp on battery negative (-) cable from relay box
- Battery negative (-) cable from right fender apron
- Battery positive (+) terminal cable

### 13. REMOVE SHIFT LEVER ASSEMBLY AND TRANSFER SHIFT LEVER ASSEMBLY

- (a) Remove the transfer shift lever knob.
- (b) Remove the upper console panel.

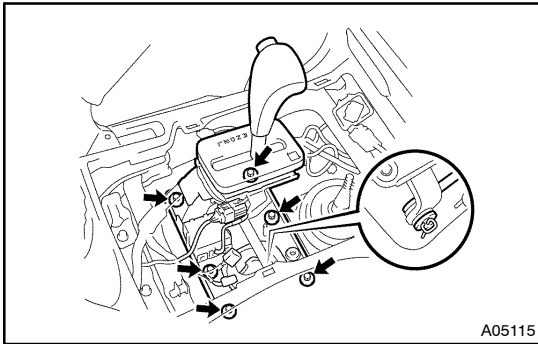

- (c) Remove the shift lever assembly.
  - (1) Disconnect the connector.
  - (2) Remove the 6 bolts.
  - (3) Remove the clip and plate washer, and disconnect the transmission control rod from the shift lever assembly.
  - (4) Remove the shift lever assembly.
- (d) Remove the 4 bolts and transfer shift lever boot.

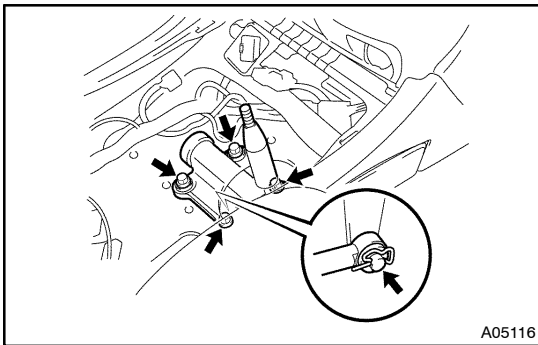

- (e) Remove the transfer shift lever assembly.
  - (1) Remove the clip, plate washer and wave washer, and disconnect the transfer rod from the shift lever.
  - (2) Remove the bushing.
  - (3) Remove the 4 bolts, shift lever and gasket.

### 14. REMOVE FRONT EXHAUST PIPES

### 15. REMOVE PROPELLER SHAFT (See page [PR-4](#))

### 16. REMOVE STABILIZER BAR (See page [SA-78](#))

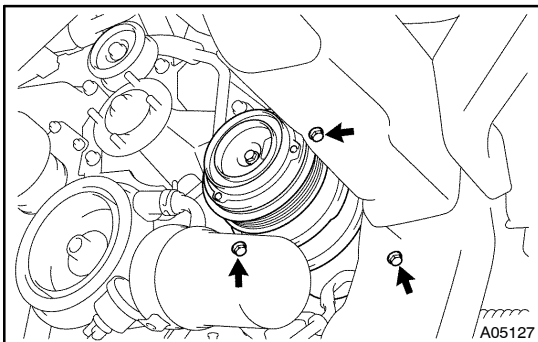

### 17. DISCONNECT A/C COMPRESSOR FROM ENGINE

- (a) Disconnect the A/C compressor connector.
- (b) Remove the 3 bolts, and disconnect the A/C compressor from the engine.

#### HINT:

Suspend the A/C compressor securely.

**18. DISCONNECT PS PUMP FROM ENGINE**

Remove the 3 bolts, and disconnect the PS pump from the engine.

HINT:

Suspend the PS pump securely.

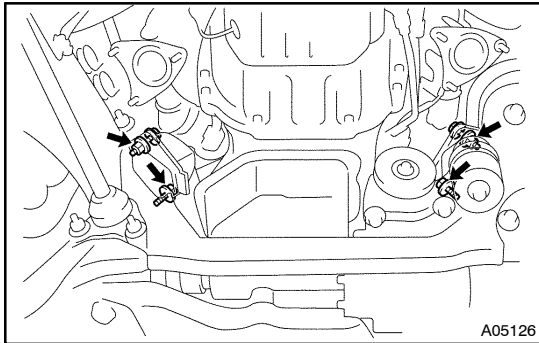
**19. REMOVE ENGINE AND TRANSMISSION ASSEMBLY FROM VEHICLE**

- (a) Attach the engine chain hoist to the engine hangers.
- (b) Remove the 2 nuts and 4 bolts holding the engine mounting brackets to the frame brackets.
- (c) Remove the 3 bolts and transfer case protector.

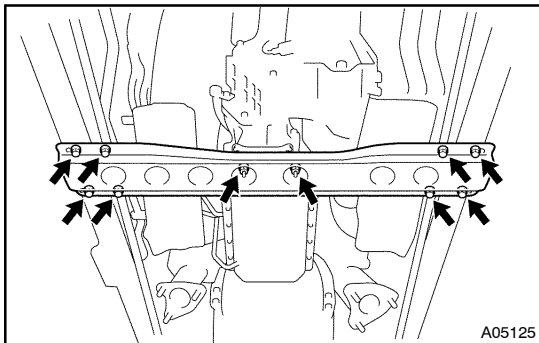

- (d) Remove the 8 bolts, 2 nuts and frame crossmember.

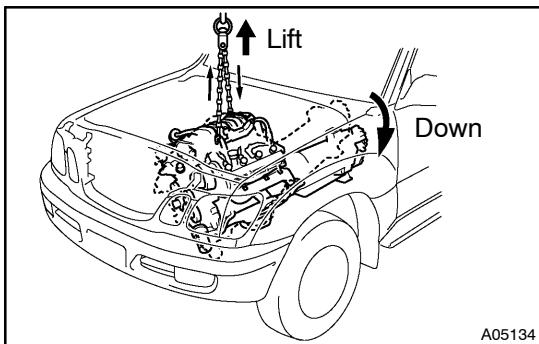

- (e) Lift the engine out of the vehicle slowly and carefully.

HINT:

Make sure the engine is clear of all wiring, hoses and cables.

- (f) Place the engine and transmission assembly onto the stand.

**20. DISCONNECT ENGINE WIRE FROM TRANSMISSION**

- (a) Disconnect the 5 connectors.
- (b) Disconnect the 2 wire clamps.

**21. REMOVE OIL DIPSTICK GUIDE AND DIPSTICK FOR TRANSMISSION**

- (a) Disconnect the 2 breather hoses from the dipstick guide.
- (b) Remove the 2 bolts.
- (c) Pull out the dipstick guide and dipstick from the dipstick tube of transmission.
- (d) Remove the O-ring from the dipstick guide.

**22. REMOVE OIL COOLER PIPES FOR TRANSMISSION**

- (a) Remove the 3 bolts and 3 stays.
- (b) Loosen the 2 union nuts, and remove the 2 oil cooler pipes.

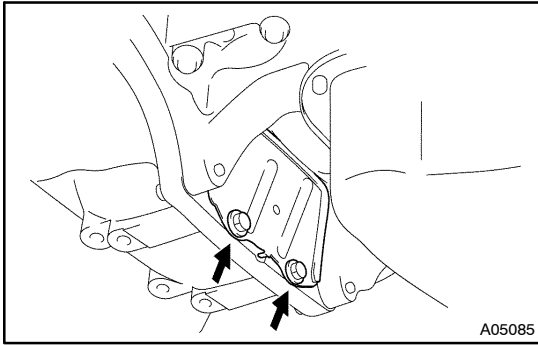

### 23. REMOVE TORQUE CONVERTER CLUTCH BOLTS

- (a) Remove the 2 bolts and flywheel housing under cover.

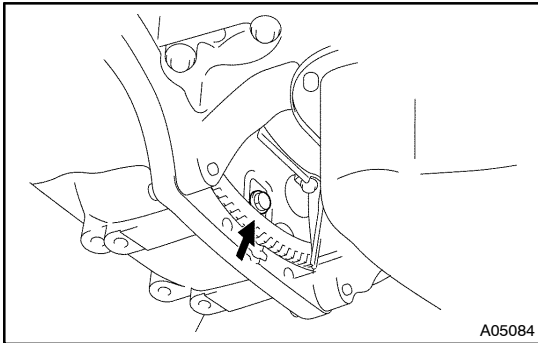

- (b) Turn the crankshaft pulley bolt to gain access to each bolt.  
(c) Hold the crankshaft pulley bolt with a wrench, and remove the 6 bolts.

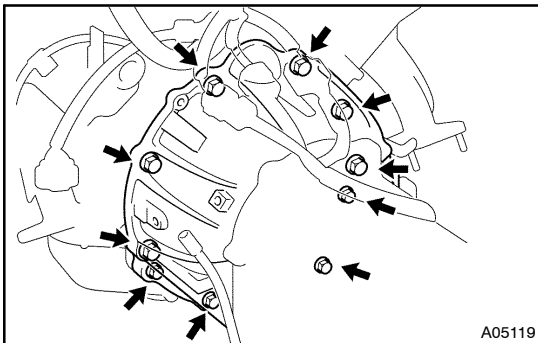

### 24. REMOVE TRANSMISSION

- (a) Remove the 10 bolts.  
(b) Remove the transmission together with the torque converter clutch from the engine.

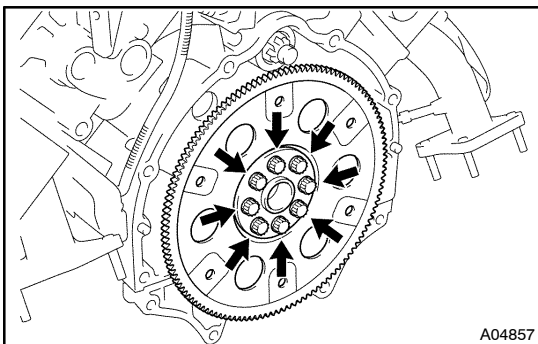

### 25. REMOVE DRIVE PLATE

Remove the 8 bolts, front spacer, drive plate and rear spacer.